



Underground operator for swing gates of up to 1.8 m per gate leaf



Gate operators tested in compliance with European Standards on the subject of impact force.

new Frog-J

The underground operator, unique and exclusive, requiring no prior fitting

Today the underground operator can be installed even without prior fittings or masonry work. All you need are 85 mm to position this revolutionary system which blends aesthetic value into Came's technological edge.





CAME
AUTOMATIC GATES

Frog-J

Just 85 mm of underground automation!

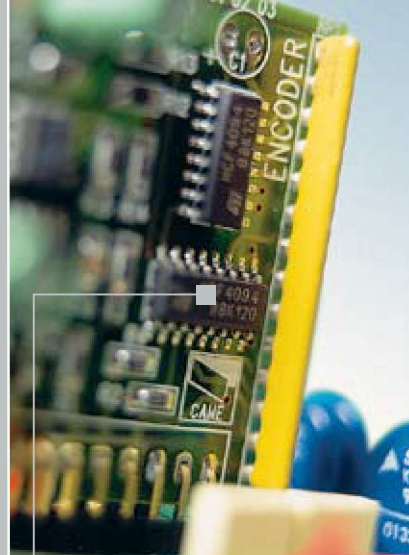

Came's latest solution for installing an underground operator even when gates are not previously fitted to do so. In fact, Frog-J needs very little space. Requiring little, if any masonry work, it adds the value of an underground system to that of one with no extra costs. It's a Came solution!



EN12445 - EN12453 compliant.
Through the encoder, the dedicated panel constantly controls the gate leaves' movement allowing for safe thrust, and is EU standard compliant.

Innovative and exclusive integrated release system with custom key.

It is comfortable, safe, waterproof, and protected by its water sealed door. Which makes it easy to reach whether you are outside and inside the gate.

Blackouts no more!

Frog-J's 24V electronics will automatically read any power outages and turn on the emergency mode which runs on batteries added to the unit (accessories).

The electronics

Besides the normal command and safety functions, Frog-J's new electronics provides certain new additions which give you total control of the operator and an optimal service level, these being:

> Movement monitoring through ENCODER:

to control the gate's run, its thrust and slow downs, while being totally safe for the user.

> Dedicated control panel:

which takes emergency batteries and recharge card to deal with blackout situations.

> Easier to install:

using just one tri-polar cable to handle the power supply and slow downs.

Limits to use

Gate leaf width (m)	Gate leaf weight (kg)
0,8	150
1,2	125
1,8	2100

The range

- FROG-J** 24V A.C. operator with encoder.
- FROG-JC** Foundation casing.
- A4617** Custom-key release.
- ZL90** Control panel.
- LB90** Card for emergency batteries.

Dimensions

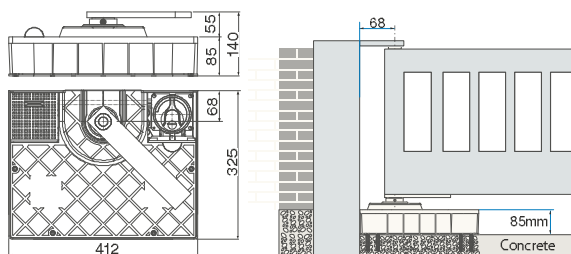

Technical features

Type	FROG-J
Protection rating	IP67
Power supply (V)	230 A.C. 50/60 Hz
Motor power supply (V)	24 D.C.
Current draw (A)	10
Max power (W)	240
Thrust (N)	260
Duty cycle (%)	intensive use
Opening time 90° (s)	adjustable
Operating temperature (°C)	-20 ÷ +55

Standard installation

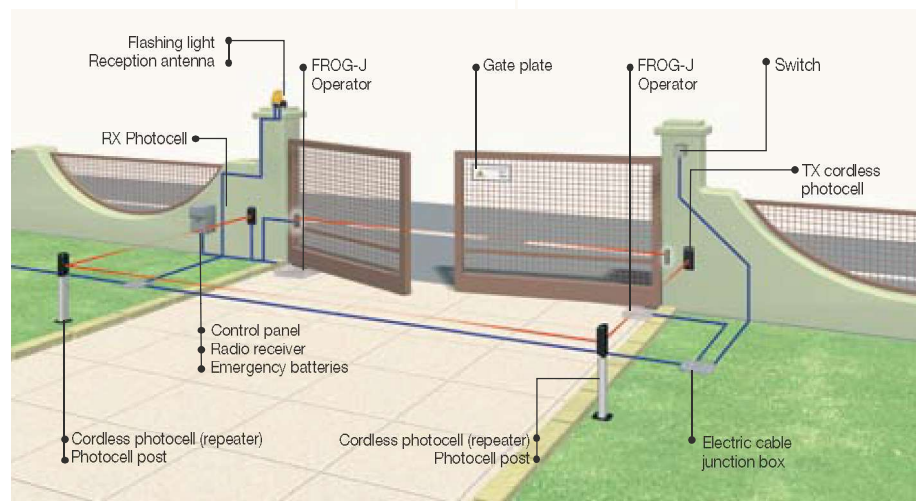

The data and information shown in this catalogue are subject to change without the obligation to give prior notice by Came cancelli automatici S.p.A.

PRODUCTS



Made in Italy



Came cancelli automatici s.p.a.

via Martiri della Libertà, 15
31030 Dosson di Casier - Treviso - Italy

www.came.it - info@came.it



© Came DEP5771 06/2007